



**GE Healthcare  
Project Management**

GE Healthcare has made reasonable efforts to ensure this BIM file conforms to requirements of the applicable pre-installation manual. This BIM file was produced to assist with site planning and is not intended for construction or final building modeling. GE Healthcare is not responsible for any damages resulting from use of such file for construction or final building modeling purposes. Compliance with all applicable local, state, and federal laws and regulations is the responsibility of the customer or its designated architects and engineers. Please keep in mind the information in this BIM file is dynamic and is subject to change without notice. It is the responsibility of the customer or its designated architect(s) and engineer(s) to ensure they have the latest equipment or product information.

**Signa Creator/Explorer - RENDERING**

<b>Project number</b>	-
<b>Date</b>	23.FEB.17
<b>Drawn by</b>	Genpact
<b>Checked by</b>	-

**A-1**

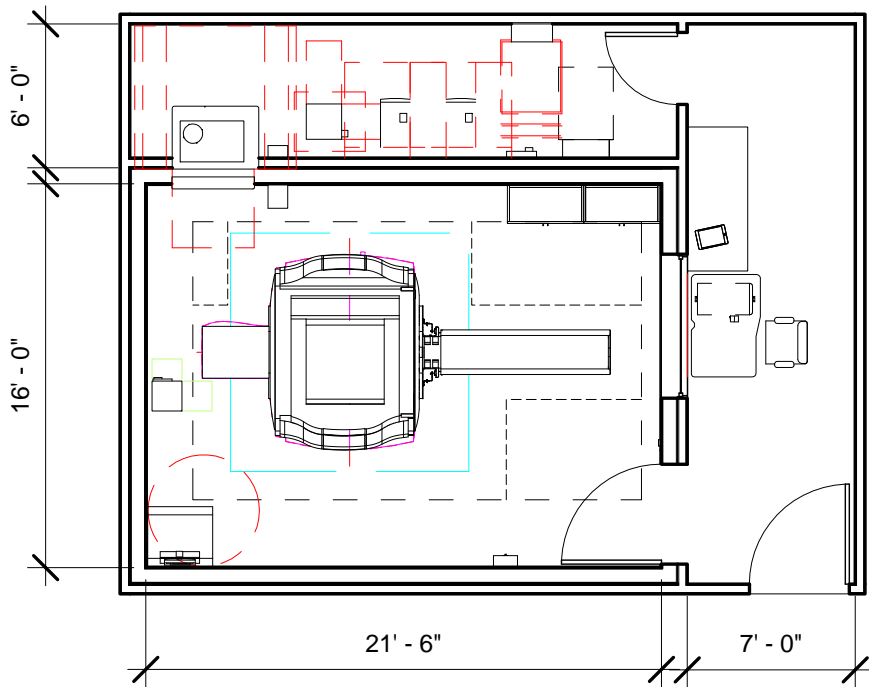

Specialty Equipment Schedule		
Description	Weight lbs	BTU
1.5 T Magnet	13115	8191
PATIENT TRANSPORT TABLE	279	0
SPT PHANTOM CABINET	350	0
BLOWER BOX	46	3412
SHIELD COOLER CABINET	264	1706
MAIN DISCONNECT CONTROL	350	900
MAGNET RUNDOWN UNIT	8	0
MAGNET MONITOR	11	819
ROOM SUPPLY CABINET	0	0
ROOM SUPPLY CABINET	0	0
OPERATOR WORKSPACE WITH LCD MONITOR	0	4948
OPERATOR WORKSPACE CABINET	141	0
PATIENT ALERT CONTROL BOX	0	0
WORKSTATION TABLE	0	0
PET CHILLER	350	0
PET CHILLER	350	0
DC LIGHTING CONTROL PANEL	155	1024
DC LIGHTING TRANSFORMER	60	171
BLOWER BOX	1962	17064



**GE Healthcare**  
Project Management

GE Healthcare has made reasonable efforts to ensure this BIM file conforms to requirements of the applicable pre-installation manual. This BIM file was produced to assist with site planning and is not intended for construction or final building modeling. GE Healthcare is not responsible for any damages resulting from use of such file for construction or final building modeling purposes. Compliance with all applicable local, state, and federal laws and regulations is the responsibility of the customer or its designated architects and engineers. Please keep in mind the information in this BIM file is dynamic and is subject to change without notice. It is the responsibility of the customer or its designated architect(s) and engineer(s) to ensure they have the latest equipment or product information.

Signa Creator/Explorer - PLAN

Project number	8-254
Date	23.FEB.17
Drawn by	Genpact
Checked by	-

**A-2**

Scale 1/8" = 1'-0"

Hold the Left Click for Rotating around  
Use the Scroll for Zooming in and out  
Hold Left click + Ctrl Key to change perspective



Optima MR360 - Brivo MR355



GE Healthcare

[Click for Site Planning Support](#)