



**GE Healthcare  
Project Management**

GE Healthcare has made reasonable efforts to ensure this BIM file conforms to requirements of the applicable pre-installation manual. This BIM file was produced to assist with site planning and is not intended for construction or final building modeling. GE Healthcare is not responsible for any damages resulting from use of such file for construction or final building modeling purposes. Compliance with all applicable local, state, and federal laws and regulations is the responsibility of the customer or its designated architects and engineers. Please keep in mind the information in this BIM file is dynamic and is subject to change without notice. It is the responsibility of the customer or its designated architect(s) and engineer(s) to ensure they have the latest equipment or product information.

**DISCOVERY XR650 - RENDERING**

<b>Project number</b>	<b>1-140</b>
<b>Date</b>	<b>01.JUNE.17</b>
<b>Drawn by</b>	<b>GENPACT</b>
<b>Checked by</b>	

**A-1**

**Scale 12" = 1'-0"**

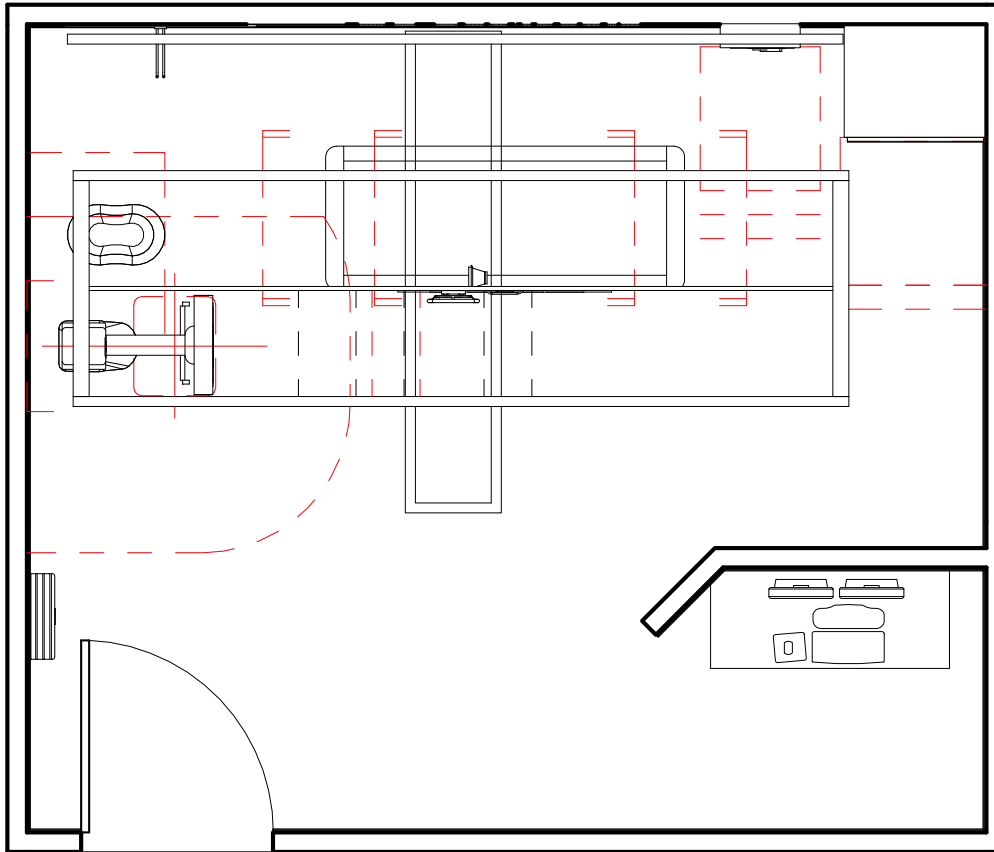

Specialty Equipment Schedule		
Description	Weight (lbs)	BTU
<b>EXAM ROOM</b>		
LONGITUDINAL STATIONARY RAIL	68	0
CABLE DRAPE RAIL	180	0
XT RADIOGRAPHIC SUSPENSION WITH INBOARD MOUNTING	559	501
TRAD DIGITAL ELEVATING TABLE	992	426
TRAD DETECTOR SUPPORT		0
FIXED DETECTOR CHEST UNIT	595	109
SYSTEM CABINET	679	2436
LONGITUDINAL DRIVE BELT	44	0
MAIN DISCONNECT, REFERENCE JUNCTION POINT 'A' ON SHEET E1 FOR DETAILED DESCRIPTION. CAT. NO. E4502ST OR WITH AUTO RESTART E4502RP. (20 W x 48 H x 6.68 in. D)	0	0
GRID HOLDER	30	0
DETECTOR SUPPORT ASSEMBLY	85	2047
OPERATORS CONSOLE	99	986



**GE Healthcare  
Project Management**

GE Healthcare has made reasonable efforts to ensure this BIM file conforms to requirements of the applicable pre-installation manual. This BIM file was produced to assist with site planning and is not intended for construction or final building modeling. GE Healthcare is not responsible for any damages resulting from use of such file for construction or final building modeling purposes. Compliance with all applicable local, state, and federal laws and regulations is the responsibility of the customer or its designated architects and engineers. Please keep in mind the information in this BIM file is dynamic and is subject to change without notice. It is the responsibility of the customer or its designated architect(s) and engineer(s) to ensure they have the latest equipment or product information.

**DISCOVERY XR650 - PLAN & SCHEDULE**

Project number	1-140
Date	01.JUNE.17
Drawn by	GENPACT
Checked by	

**A-2**

Scale 1/4" = 1'-0"

Hold the Left Click for Rotating around  
Use the Scroll for Zooming in and out



1-140 - Discovery XR650



GE Healthcare

[Click for Site Planning Support](#)