



GE Healthcare
Project Management

GE Healthcare has made reasonable efforts to ensure this BIM file conforms to requirements of the applicable pre-installation manual. This BIM file was produced to assist with site planning and is not intended for construction or final building modeling. GE Healthcare is not responsible for any damages resulting from use of such file for construction or final building modeling purposes. Compliance with all applicable local, state, and federal laws and regulations is the responsibility of the customer or its designated architects and engineers. Please keep in mind the information in this BIM file is dynamic and is subject to change without notice. It is the responsibility of the customer or its designated architect(s) and engineer(s) to ensure they have the latest equipment or product information.

REVOLUTION DISCOVERY GSI/HD - RENDERING

Project number	6-102
Date	11-MAY-2017
Drawn by	GENPACT
Checked by	

A-1

Scale 12" = 1'-0"

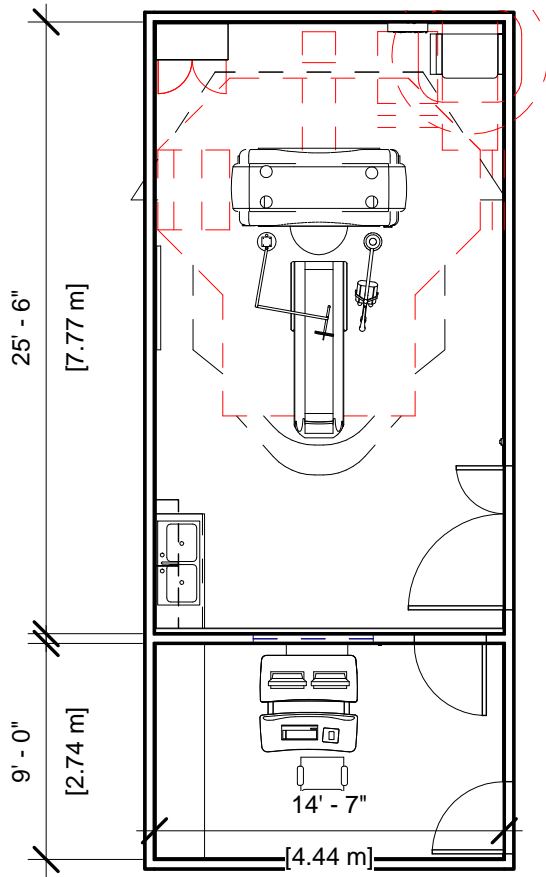

Specialty Equipment Schedule

Description	Weight (lbs)	BTU
CONTROL ROOM		
OPERATORS CONSOLE	568	6000
EXAM ROOM		
MAIN DISCONNECT	125	0
STORAGE CABINET	99	0
POWER DISTRIBUTION UNIT	798	0
CT TABLE	1047	0
REVOLUTION DISCOVERY CT/DISCOVERY CT GANTRY	3884	33297
MONITOR ON OVERHEAD COUNTERPOISED SUSPENSION	61	300
INJECTOR HEAD ON OVERHEAD COUNTERPOISED SUSPENSION	79	0



GE Healthcare
Project Management

GE Healthcare has made reasonable efforts to ensure this BIM file conforms to requirements of the applicable pre-installation manual. This BIM file was produced to assist with site planning and is not intended for construction or final building modeling. GE Healthcare is not responsible for any damages resulting from use of such file for construction or final building modeling purposes. Compliance with all applicable local, state, and federal laws and regulations is the responsibility of the customer or its designated architects and engineers. Please keep in mind the information in this BIM file is dynamic and is subject to change without notice. It is the responsibility of the customer or its designated architect(s) and engineer(s) to ensure they have the latest equipment or product information.

REVOLUTION DISCOVERY GSI/HD PLAN VIEW & SCHEDULE

Project number	6-102
Date	11-MAY-2017
Drawn by	GENPACT
Checked by	

A-2

Scale 1/8" = 1'-0"

Hold the Left Click for Rotating around
Use the Scroll for Zooming in and out



6-102 Revolution Discovery CT GSIHD w1700 Table



GE Healthcare

[Click for Site Planning Support](#)