



GE Healthcare
Project Management

GE Healthcare has made reasonable efforts to ensure this BIM file conforms to requirements of the applicable pre-installation manual. This BIM file was produced to assist with site planning and is not intended for construction or final building modeling. GE Healthcare is not responsible for any damages resulting from use of such file for construction or final building modeling purposes. Compliance with all applicable local, state, and federal laws and regulations is the responsibility of the customer or its designated architects and engineers. Please keep in mind the information in this BIM file is dynamic and is subject to change without notice. It is the responsibility of the customer or its designated architect(s) and engineer(s) to ensure they have the latest equipment or product information.

SIGNA VOYAGER - RENDERING

Project number	8-270
Date	14.SEP.17
Drawn by	GENPACT
Checked by	

A-1

Scale 12" = 1'-0"

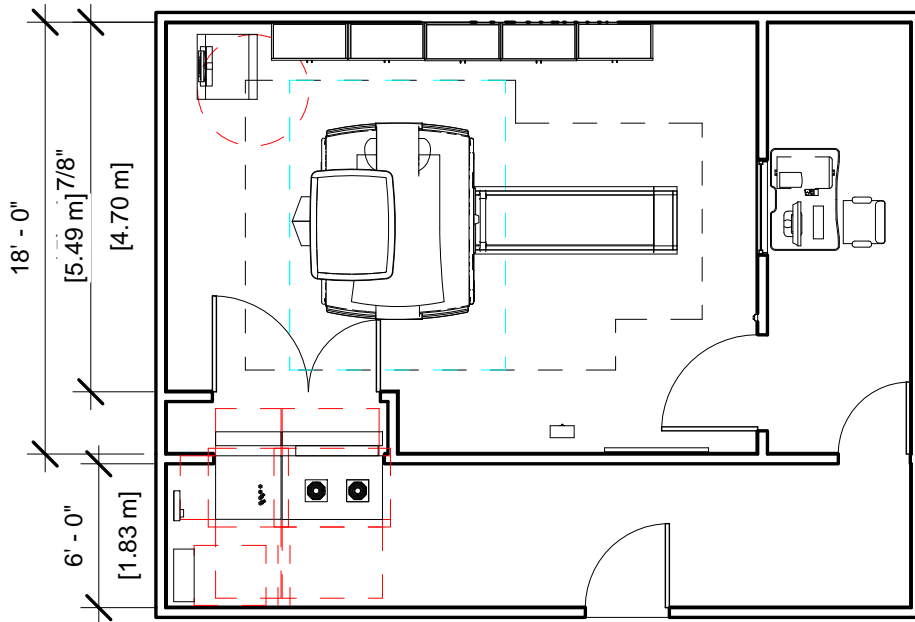

Specialty Equipment Schedule

Description	Weight (lbs)	BTU
CONTROL ROOM		
OPERATOR WORKSPACE WITH LCD MONITOR	0	4948
OPERATOR WORKSPACE CABINET	141	0
PATIENT ALERT CONTROL BOX	0	0
WORKSTATION TABLE	0	0
EQUIPMENT ROOM		
MAIN DISCONNECT CONTROL	130	901
INTEGRATED COOLING CABINET	1033	3412
INTEGRATED SYSTEMS CABINET	2557	24232
MAGNET MONITOR	11	819
EXAM ROOM		
SPT PHANTOM CABINET	350	0
MAGNET RUNDOWN UNIT	8	0
ROOM SUPPLY CABINET	0	0
ROOM SUPPLY CABINET	0	0
ROOM SUPPLY CABINET	0	0
ROOM SUPPLY CABINET	0	0
ROOM SUPPLY CABINET	0	0
3.0 TESLA ACTIVE SHIELD MAGNET (and table)	11728	8191



GE Healthcare
Project Management

GE Healthcare has made reasonable efforts to ensure this BIM file conforms to requirements of the applicable pre-installation manual. This BIM file was produced to assist with site planning and is not intended for construction or final building modeling. GE Healthcare is not responsible for any damages resulting from use of such file for construction or final building modeling purposes. Compliance with all applicable local, state, and federal laws and regulations is the responsibility of the customer or its designated architects and engineers. Please keep in mind the information in this BIM file is dynamic and is subject to change without notice. It is the responsibility of the customer or its designated architect(s) and engineer(s) to ensure they have the latest equipment or product information.

SIGNA VOYAGER - PLAN & SCHEDULE

Project number	8-270
Date	14.SEP.17
Drawn by	GENPACT
Checked by	

A-2

Scale 1/8" = 1'-0"

Hold the Left Click for Rotating around
Use the Scroll for Zooming in and out



8-270 - Signa Voyager



GE Healthcare

[Click for Site Planning Support](#)