



GE Healthcare has made reasonable efforts to ensure this BIM file conforms to requirements of the applicable pre-installation manual. This BIM file was produced to assist with site planning and is not intended for construction or final building modeling. GE Healthcare is not responsible for any damages resulting from use of such file for construction or final building modeling purposes. Compliance with all applicable local, state, and federal laws and regulations is the responsibility of the customer or its designated architects and engineers. Please keep in mind the information in this BIM file is dynamic and is subject to change without notice. It is the responsibility of the customer or its designated architect(s) and engineer(s) to ensure they have the latest equipment or product information.



Healthcare
Project Implementation

BRIGHTSPEED SELECT - Rendering

Project number 6-62R

Date 16.MAY.2012

Drawn by DMH

Checked by DMH

A-1

Scale

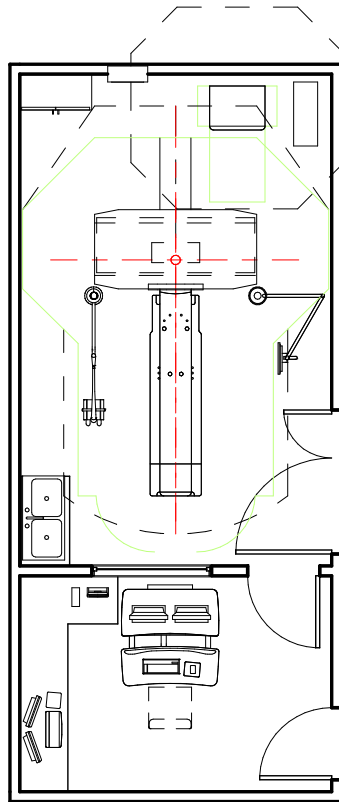

Equipment Schedule

Description	Weight	BTU
LCD MONITOR	61	300
STORAGE CABINET	90	0
INJECTOR MAIN UNIT	13	0
INJECTOR CONTROL CONSOLE	8	0
INJECTOR HEAD ON OVERHEAD COUNTERPOISED SUSPENSION	22	0
OPERATORS CONSOLE/COMPUTER	469	8191
POWER DISTRIBUTION UNIT	771	5119
UPS SYSTEM	350	0
BRIGHTSPEED SELECT GANTRY	3899	18778
ADVANTAGE WORKSTATION	81	1109
MAIN DISCONNECT CONTROL	90	0



Healthcare
Project Implementation

BRIGHTSPEED SELECT

Project number 6-62R

Date 16.MAY.2012

Drawn by DMH

Checked by DMH

A-2

Scale 1/8" = 1'-0"

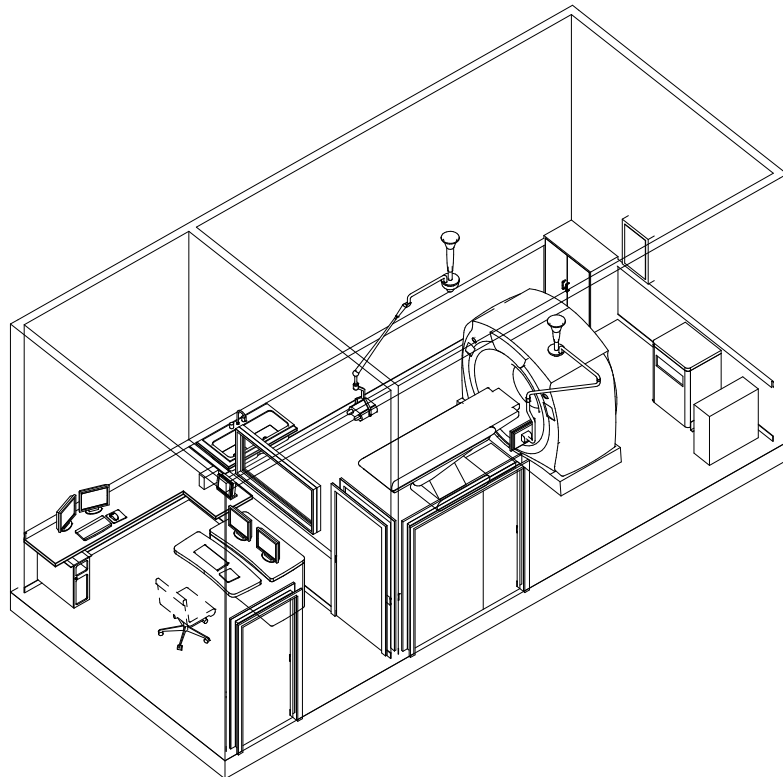

Healthcare
Project Implementation

BRIGHTSPEED SELECT - Isometric View

Project number 6-62R

Date 16.MAY.2012

Drawn by DMH

Checked by DMH

A-3

Scale