



**GE Healthcare**  
**Project Management**

GE Healthcare has made reasonable efforts to ensure this BIM file conforms to requirements of the applicable pre-installation manual. This BIM file was produced to assist with site planning and is not intended for construction or final building modeling. GE Healthcare is not responsible for any damages resulting from use of such file for construction or final building modeling purposes. Compliance with all applicable local, state, and federal laws and regulations is the responsibility of the customer or its designated architects and engineers. Please keep in mind the information in this BIM file is dynamic and is subject to change without notice. It is the responsibility of the customer or its designated architect(s) and engineer(s) to ensure they have the latest equipment or product information.

**DISCOVERY PER/CT 690 ELITE - RENDERING**

<b>Project number</b>	<b>12-22</b>
<b>Date</b>	<b>07.JULY.17</b>
<b>Drawn by</b>	<b>GENPACT</b>
<b>Checked by</b>	

**A1**

**Scale 12" = 1'-0"**

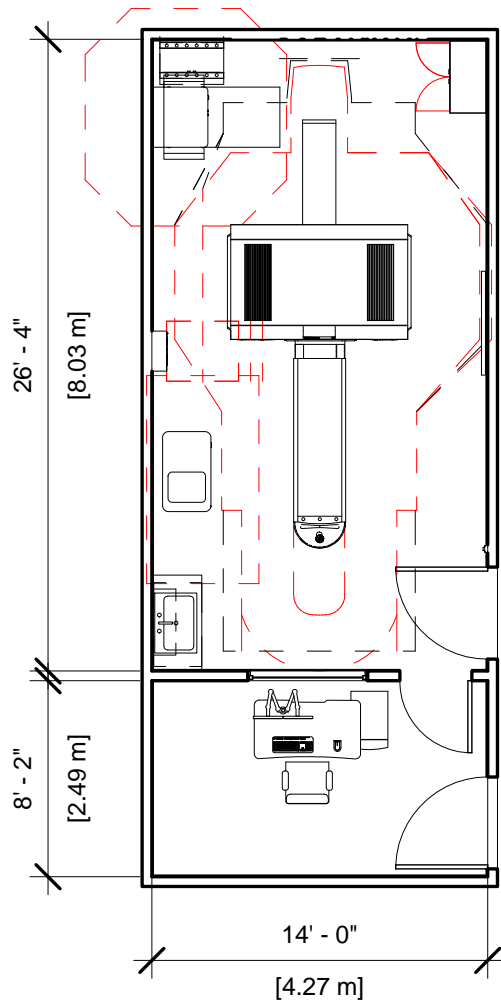

### Specialty Equipment Schedule

Description	Weight (lbs)	BTU
CONTROL ROOM		
LARGE TABLE OPERATOR'S CONSOLE	341	8191
EXAM ROOM		
POWER DISTRIBUTION UNIT	800	3399
PARC	701	7505
MAIN DISCONNECT CONTROL CAT NO. E4502AB (IF A UPS IS NOT OR WILL NOT BE ORDERED, THE E4502AD CAN BE USED.)	90	0
STORAGE CABINET	99	0
DISCOVERY PET/CT 600	8529	24744
PATIENT TABLE (WITHOUT PATIENT)	1803	1023
UPS	619	5122



**GE Healthcare  
Project Management**

GE Healthcare has made reasonable efforts to ensure this BIM file conforms to requirements of the applicable pre-installation manual. This BIM file was produced to assist with site planning and is not intended for construction or final building modeling. GE Healthcare is not responsible for any damages resulting from use of such file for construction or final building modeling purposes. Compliance with all applicable local, state, and federal laws and regulations is the responsibility of the customer or its designated architects and engineers. Please keep in mind the information in this BIM file is dynamic and is subject to change without notice. It is the responsibility of the customer or its designated architect(s) and engineer(s) to ensure they have the latest equipment or product information.

#### DISCOVERY PER/CT 690 ELITE - PLAN & SCHEDULE

Project number	12-22
Date	07.JULY.17
Drawn by	GENPACT
Checked by	

**A2**

Scale 1/8" = 1'-0"

Hold the Left Click for Rotating around  
Use the Scroll for Zooming in and out



12-22 - Discovery PET-CT 690 Elite



[Click for Site Planning Support](#)