



GE Healthcare
Project Management

GE Healthcare has made reasonable efforts to ensure this BIM file conforms to requirements of the applicable pre-installation manual. This BIM file was produced to assist with site planning and is not intended for construction or final building modeling. GE Healthcare is not responsible for any damages resulting from use of such file for construction or final building modeling purposes. Compliance with all applicable local, state, and federal laws and regulations is the responsibility of the customer or its designated architects and engineers. Please keep in mind the information in this BIM file is dynamic and is subject to change without notice. It is the responsibility of the customer or its designated architect(s) and engineer(s) to ensure they have the latest equipment or product information.

OPTIMA IGS 320 & 330 SYSTEM - RENDERING

Project number	4-100
Date	13.DEC.16
Drawn by	Genpact
Checked by	-

A-1

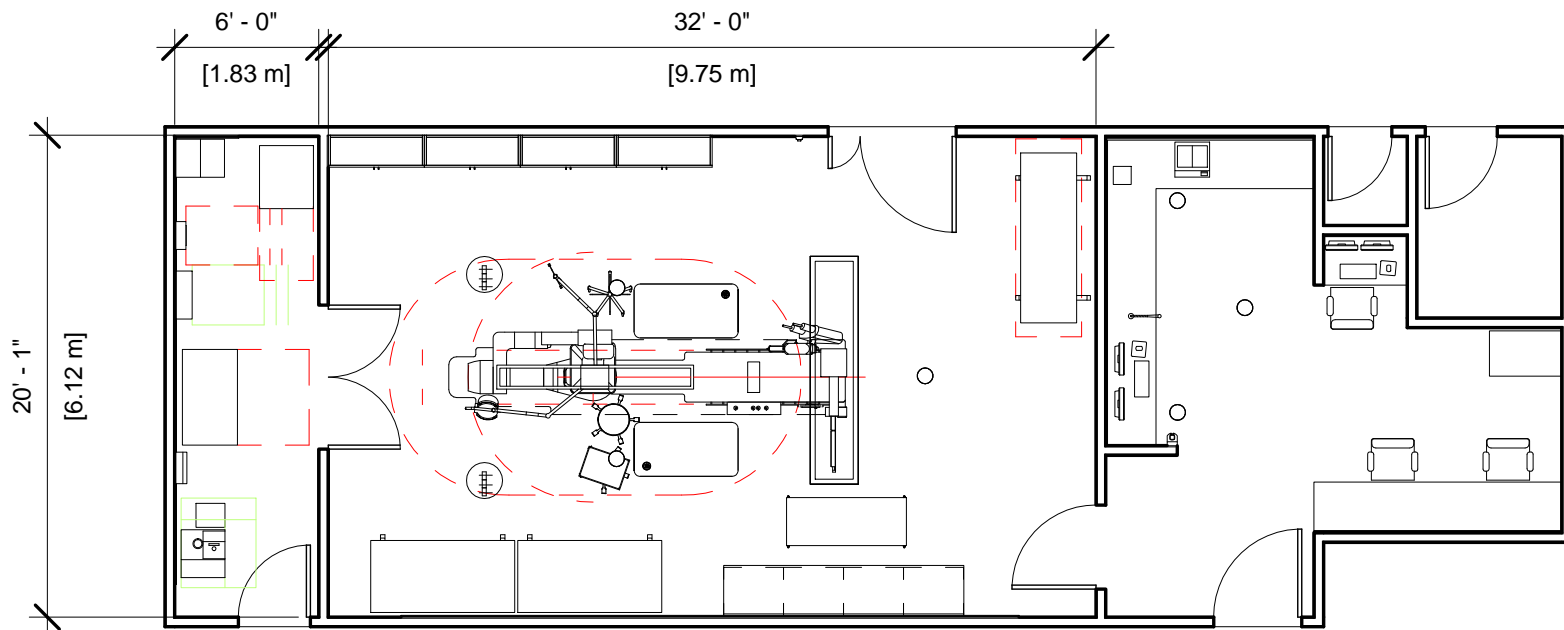

GE Healthcare
Project Management

GE Healthcare has made reasonable efforts to ensure this BIM file conforms to requirements of the applicable pre-installation manual. This BIM file was produced to assist with site planning and is not intended for construction or final building modeling. GE Healthcare is not responsible for any damages resulting from use of such file for construction or final building modeling purposes. Compliance with all applicable local, state, and federal laws and regulations is the responsibility of the customer or its designated architects and engineers. Please keep in mind the information in this BIM file is dynamic and is subject to change without notice. It is the responsibility of the customer or its designated architect(s) and engineer(s) to ensure they have the latest equipment or product information.

OPTIMA IGS 320 & 330 SYSTEM - PLAN

Project number	4-100
Date	13.DEC.16
Drawn by	Genpact
Checked by	-

A-2

Scale 1/8" = 1'-0"

Specialty Equipment Schedule

Description	Weight (lbs)	Weight (kg)	BTU	Watts
-------------	--------------	-------------	-----	-------

INJECTOR ELECTRONICS	37		320	
----------------------	----	--	-----	--

Control Room

VATALINQ SPEAKER	0		0	
VATALINQ SPEAKER	0		0	
VATALINQ SPEAKER	0		0	
VATALINQ CONSOLE	0		0	
AW WORKSTATION	81		1201	
AW WORKSTATION	81		1201	
AW WORKSTATION	81		1201	
AW WORKSTATION	81		1201	
COLOR PRINTER	0		1054	
COLOR PRINTER	0		1054	
REMOTE CONTROL FOR INJECTOR	4		0	
OPERATORS CONSOLE WITH DL KEYPAD	22		546	
OPERATORS CONSOLE	22		546	
BOLUS CHASE HANDSWITCH	0		0	
AW WORKSTATION	81		1201	
VITALINQ MICROPHONE DESK	0		0	
CUSTOMER SUPPLIED STORAGE CABINET	0		0	

Equipment Room

UPS INTERFACE BOX	0		0	
INNOVA MAIN DISCONNECT	326		1532	
UPS CABINET	1170		4061	
LOTO DISCONNECT	0		0	
COOLIX 4100 AUTOTRANSFORMER	66		238	
COOLIX 4100 WATER CHILLER	264		18730	
DETECTOR CHILLER	33		706	

Specialty Equipment Schedule

Description	Weight (lbs)	Weight (kg)	BTU	Watts
-------------	--------------	-------------	-----	-------

SYSTEMS CONTROL CABINET	1415		52180	00000
-------------------------	------	--	-------	-------

Exam Room

ROOM SUPPLY CABINET	0		0	
ROOM SUPPLY CABINET	0		0	
ROOM SUPPLY CABINET	0		0	
ROOM SUPPLY CABINET	0		0	
VATALINQ SPEAKER	0		0	
VATALINQ SPEAKER	0		0	
VATALINQ SPEAKER	0		0	
COUNTERBALANCED EYE AND THYROID SHIELD WITH R96 LAMP	143		0	
CABLE DRAPE RAIL	180		0	
LONGITUDINAL STATIONARY RAIL	68.00		0	
INNOVA POSITIONER	1653		2416	
TRAM NET RACK	8		0	
TRAM NET RACK	8		0	
TRAM NET RACK	8		0	
MED GASES IN CEILING	0		0	
MED GASES IN CEILING	0		0	
OMEGA V TABLE	1300		614	
SIX LCD MONITOR SUSPENSION	485		1157	
STRETCHER MOBILE TABLE	70		0	
SCRUB MOBILE TABLE	70		0	
SCRUB MOBILE TABLE	70		0	
STERILE MOBILE TABLE	70		0	
INJECTOR HEAD ON TABLE RAIL	15		0	



**GE Healthcare
Project Management**

GE Healthcare has made reasonable efforts to ensure this BIM file conforms to requirements of the applicable pre-installation manual. This BIM file was produced to assist with site planning and is not intended for construction or final building modeling. GE Healthcare is not responsible for any damages resulting from use of such file for construction or final building modeling purposes. Compliance with all applicable local, state, and federal laws and regulations is the responsibility of the customer or its designated architects and engineers. Please keep in mind the information in this BIM file is dynamic and is subject to change without notice. It is the responsibility of the customer or its designated architect(s) and engineer(s) to ensure they have the latest equipment or product information.

OPTIMA IGS 320 & 330 SYSTEM - SCHEDULE

Project number	4-100	A-3
Date	13.DEC.16	
Drawn by	Author	
Checked by	Checker	

Hold the Left Click for Rotating around
Use the Scroll for Zooming in and out



Optima IGS 320 and 330 System



GE Healthcare

[Click for Site Planning Support](#)